



## FACILITIES MANAGEMENT

Independent School District No. 709

*Located at 101 East 3rd Street*

*Mailing Address: 215 North 1st Avenue East*

Duluth, Minnesota 55802

Construction Management (218) 336-8907

Maintenance (218) 336-8906

Operations (218) 336-8905

Fax (218) 336-8909

July 24, 2009

Ms. Audrey Bomstad  
MN Dept. of Children Families & Learning  
1500 Highway 36 West  
Roseville, MN 55113-4266

RE: Request for additional information relating to June 30, 2009 Review and Comment -  
Lincoln/Piedmont Play Areas

Dear Audrey:

As requested in your July 20, 2009 e-mail, the following information and attachments are provided to respond to your questions:

1. "Could you please send dimensions of the two areas designated for playground/recreation located on the site?"

Response- Please refer to Attachment No. 1 for dimensions of playground/recreation area.

2. "Please provide an explanation of the anticipated activity by 500 students on the those areas – detail as to curricular use, use for recess, number of students and grade levels using the site by hours, etc.."

Response- The equipment and play area apparatus is sized for the planned number of students based on three lunch periods. The capacity of play equipment is a calculated factor provided by play equipment manufacturers, and based on the District's experience. These apparatus are chosen and sized to provide safe play activity for children ages 5 – 12 years. The equipment and play apparatus at this site is sized similar in type and quantity to the District's other elementary schools. Please refer to attachment No. 2 for schematic of equipment layout planned for these areas and also note the five areas of fall zone that are currently undesignated at this time to allow for additional future apparatus.

These apparatus have been chosen with input from District physical education specialists with the expectation that they will be used at times to support their physical education curriculum and used for classes of 20 – 30 students.

3. "Also include an explanation of the use of the acquired land accessed by crossing Ensign as to curricular, recess, etc., and supervision assumed for street crossing."

Response- The existing playfields area behind the church are planned for use to support physical education curriculum for classes of 20 – 30 students where the routing and travel of students to the field areas from the school building will be guided and escorted by instructors. The street crossing from the building site across Ensign Street will include pavement markings, signage, and lights with paved walks leading from the school to the field areas. The new green space next to the church may be used seasonally for recess activities where crossings will also be supervised by playground monitors. To add to the safety of crossing if this green space is used during recess, the District is seeking a permit from the city of Duluth to place temporary barricades at the cross walk areas. Fencing along Ensign Street will further control the crossing access point location thereby increasing the safety of student pedestrian crossing.

4. "Please provide explanation of the traffic using Ensign – ie: access to the nursing home, cut-through to Piedmont, emergency access; however you would characterize street traffic." ; "Do you know the number of vehicles using the street on a daily basis?"

Response- The District initially pursued and continues to pursue the vacation of Ensign Street with the City of Duluth. The requested street vacation was approved by the City Planning Commission where the Commission and City staff deemed the street a low use and low impact street and therefore agreed and approved the District's request for the vacation of Ensign. This assessment and the decision to approve the Ensign Street vacation attests to the low use impact of Ensign in the area of the requested street vacation. Ensign Street is not a major arterial or collector street with high traffic count like Kenwood Avenue with over 10,000 average daily traffic counts. Ensign is considered by the City to be a local residential street which is defined as low speed <30mph, low traffic volume < 800-1000 and estimated to actually have < 300 cars per day.

Although the vacation of Ensign Street was approved by the City Planning Commission and recommended by City staff, this action also required a 2/3<sup>rd</sup> majority approval by the Duluth City Council. The Council's action to approve this street vacation failed with a 4-4-1 vote.

I hope this information adequately responds to your request.

Sincerely,



Kerry M. Leider  
Property and Risk Manager

Attachments

cc: Supt. Keith Dixon  
Bill Hanson  
JCI, Inc.

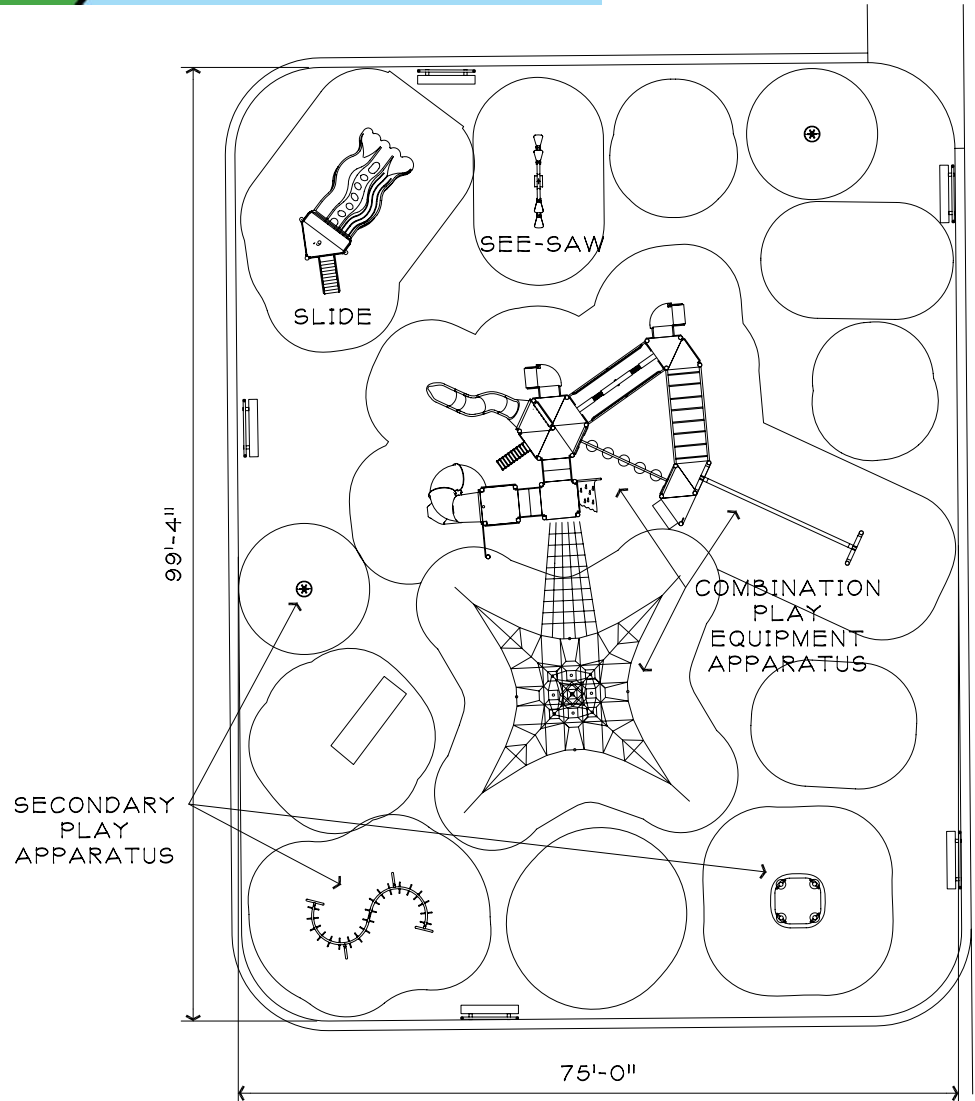
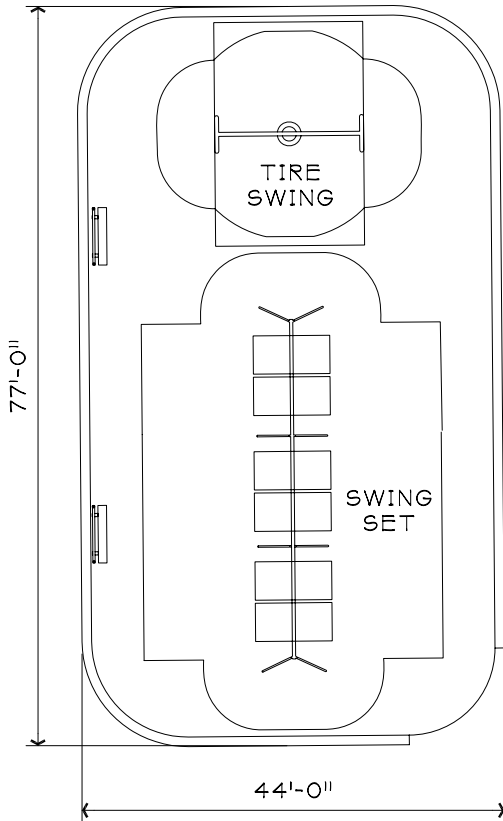
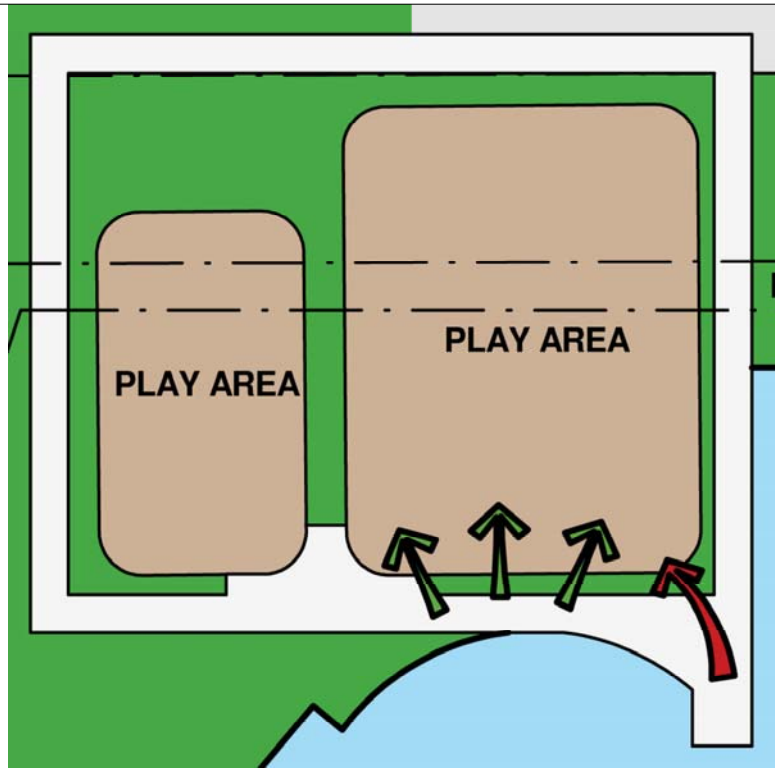

PLAY AREA PLANS  
LINCOLN/PIEDMONT ELEMENTARY